

WILSONWERKS ARCHIVES

This camera manual is for reference and historical purposes, all rights reserved.

This cover page is copyrighted material. This document may not be sold or distributed without the express consent of the publisher.

©2008 wilsonwerks Llc

INTERFACE MODULE

For use with Sunpak 'D' Series
Electronic Flash Unit

Copyright 1982, Sunpak Division,
Berkey Marketing Companies

CA-2D

For Canon
AE-1 PROGRAM,
A-1, AE-1, AL-1, AV-1,
and New F-1 Cameras

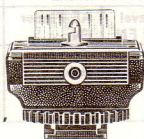

SUNPAK®



SUNPAK DIVISION
BERKEY MARKETING COMPANIES
WOODSIDE N.Y. 11377

Made and Printed in Japan

INSTRUCTIONS

The Sunpak Interface Module CA-2D is designed for all sunpak 'D' series flash units and coupled with Canon AE-1 PROGRAM, A-1, AE-1, AL-1, AV-1 and New F-1 cameras or all standard 35mm hot shoe mount cameras.

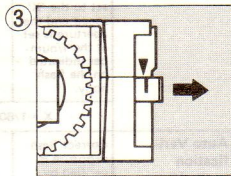
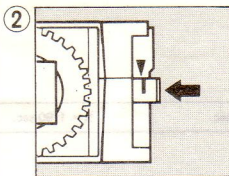
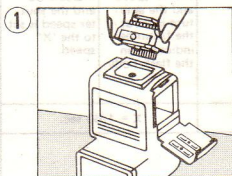

TO ATTACH THE INTERFACE MODULE TO THE FLASH BODY:

CAUTION:

- 1) Open the Battery Compartment Door.
- 2) Insert the Interface Module CA-2D into the flash body (Figure ①), and push until the marks at the Locking Lever align (Figure ②). Make sure the shoe is securely attached.
- 3) Close the Battery Compartment Door.

- 1) Place the 'D' series flash units upside down on a soft surface (cloth, rubber mat, etc.) and attach or detach the shoe while firmly holding the flash body.
- 2) The Battery Compartment Door must be opened prior to attaching or detaching the shoe.
- 3) When mounting or dismantling the Sunpak 'D' series flash units from the camera, always make sure the On/Off Switch is set at the "OFF" position or the camera may be damaged.
- 4) The 'D' series units use the power from their AA cells in the battery compartment to operate all dedicated functions. Even when an external power source is being used, it is necessary to keep the internal batteries charged to maintain electronic interface with the camera.
- 5) Electronic signals from the camera are sent through the Interface Blade. Keep the metal contacts free from dirt and grime and protect them from scratches.

TO DETACH THE INTERFACE MODULE FROM THE FLASH BODY:



- 1) Open the Battery Compartment Door.
- 2) Pull the Shoe Locking Lever out as illustrated in figure ③.
- 3) Remove the Module while holding the Locking Lever out.

ACCESSORY FOR USE WITH THE INTERFACE MODULE CA-2D:

Dedicated Remote Cord EXT-06:
Cat. No. 651-843

Ideal for off camera flash. Provides remote lighting control and better bounce effects with perfect exposure. For details, refer to the remote cord instruction manual.

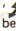
FOR CANON CAMERAS

AUTO	AE-1 PROGRAM	AE-1	New F-1 "With Motor Drive or Power-Winder" (Without Motor Drive or Power-Winder: Refer to the flash unit instructions)		A-1	AL-1/ AV-1
Viewfinder	—		Eye Level Finder FN	AE Finder FN	—	
Mode & Shutter Speed Dial Setting (on the camera)	Set the Shutter Speed Dial to any speed other than 'B'.				Set the AT dial to any position other than 'B'.	Set the Mode Selector Dial to any position other than 'B'.
Mode Selector Switch Setting (on the flash)	Set the Mode Selector Switch on the flash to one of the desired "A" position.					
Film Speed Setting	Set ASA/ISO speed in use on both the camera and flash.					
Aperture Setting	Set the aperture-ring to the 'A' position.					Set the same aperture for the flash unit's F stop.
Ready Indication in the Viewfinder	Turn the flash on and the ready light will glow after a few seconds. When the ready light glows;					
	 & 'f/number' appear in the viewfinder and the shutter speed is set to the 'X' speed and the aperture is set at the f/number indicated on the flash body.	The exposure needle points to the f/number indicated on the flash body. The shutter speed is set to the 'X' speed and the aperture is set at the f/number indicated on the flash body.	"F" appears in the viewfinder and the shutter speed is set to the 'X' speed and the aperture is set at the f/number indicated on the flash body.		The shutter speed indicator in the viewfinder will indicate 60 and the shutter speed is set to the 'X' speed.	
	X = 1/60 sec.	X = 1/90 sec.	X = 1/60 sec.			
Auto Verification in the Viewfinder	Correct flash exposure is verified by  mark in the viewfinder blinking instantly after the flash.	Refer to the flash unit instruction manual.				
Instruction for Slow Synch (Slow Synch Switch on the CA-2D)	<ul style="list-style-type: none"> • A-1: When you want to use a shutter speed of 1/30 or slower, set this switch to 'Slow' and set the mode selector on the camera to TV mode, and set the AT dial to the desired shutter speed. In this instance, the shutter speed remains at the shutter speed indicated. • New F-1: When you want to use a shutter speed of 1/60 or slower, set this switch to 'Slow' and set the shutter speed dial to the desired shutter speed. In this instance, the shutter speed remains at the shutter speed indicated. 					
Note:	When using the A-1, the aperture indication in the viewfinder may differ from F stop indicated on the flash body. But this does not affect the exposure.					
MANUAL						
Mode & Shutter Speed Dial Setting (on the camera)	Set the Shutter Speed Dial to any speed other than 'B'.			Or set the Shutter Speed Dial to 'A' position.	Set the AT dial to any position other than 'B'.	Set the Mode Selector Dial to any position other than 'B'.
Mode Selector Switch Setting (on the flash)	Set the Mode Selector Switch on the flash to the 'M' position.					
Film Speed Setting	Set the ASA/ISO for the film in use on both camera and flash.					
Aperture Setting	Disengage the aperture-ring from the 'A' position.					—
Ready Indication in the Viewfinder	Turn the flash on and the ready light will glow after a few seconds. When the ready light glows;					
	 & 'M' appear in the viewfinder, and the shutter speed is set to the 'X' speed automatically.	The 'M' in the viewfinder will blink and the shutter speed is set at the 'X' speed automatically.	The exposure needle points to the f/number indicated on the flash body. The shutter speed is set to the 'X' speed and the aperture is set at the f/number indicated on the flash body. AE Finder FN: In case of setting the Shutter Speed Dial to 'A' position: The shutter speed needle points to the between 125 and 60, and the shutter speed is set to the 'X' speed (1/90 sec.) automatically.	'F' & 'M' appear in the viewfinder, and the shutter speed is set to the 'X' speed automatically.		The shutter speed indicates 60. At this moment the shutter speed is set to the 'X' speed automatically.